

Nuclear Material Transfer Technologies and related Operational Activities at JRC Karlsruhe Hot Cells

L. Velnom, M. Uhlig, M. Van den Heuvel, M. Hauer

European Commission, Joint Research Centre, Directorate for Nuclear Safety and Security,
Postfach 2340, D-76125 Karlsruhe, Germany



Draht und Schrader 50 system

At the Joint Research Centre's (JRC) Karlsruhe site, the Waste Management unit operates the entire hot cell suite, which is the hub for fuel PIE and waste disposal studies.

Irradiated samples can be transferred to the different Hot Cells in the laboratory with a pneumatic transport system, or with appropriate shielded casks according to their size and dose rate. In addition, each cell's equipped with an enclosed conveyor channel equipped with a transfer carriage (from a capacity of 38,5l to 10l)....



Transfer with Draht und Schrader 50



*Transfer of alpha caisson
for decontamination*

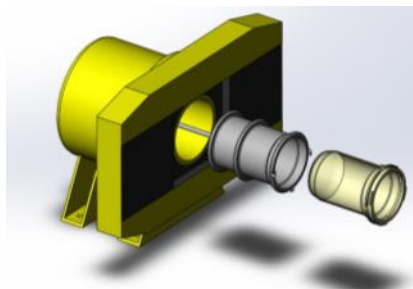

Shielded cask – 100 mm Pb



KHG remote rover with high dose sample



Sample container for EPMA, based on La Calhène